

## NSW LRS - Title Search

NEW SOUTH WALES LAND REGISTRY SERVICES - TITLE SEARCH  
-----FOLIO: 1/1001440  
-----

SEARCH DATE	TIME	EDITION NO	DATE
-----	----	-----	----
15/9/2021	1:32 PM	2	2/9/2018

NO CERTIFICATE OF TITLE HAS ISSUED FOR THE CURRENT EDITION OF THIS FOLIO.  
CONTROL OF THE RIGHT TO DEAL IS HELD BY COMMONWEALTH BANK OF AUSTRALIA.

LAND  
-----

LOT 1 IN DEPOSITED PLAN 1001440  
AT MATHOURA  
LOCAL GOVERNMENT AREA MURRAY RIVER  
PARISH OF NALLAM COUNTY OF TOWNSEND  
TITLE DIAGRAM DP1001440

FIRST SCHEDULE  
-----

CHRISTOPHER JOHN CRUMP  
DAWN CHRISTINE CRUMP  
AS JOINT TENANTS IN 1/2 SHARE  
JOEL ANDREW SMITH  
KALLI IRENE CRUMP  
AS JOINT TENANTS IN 1/2 SHARE  
AS TENANTS IN COMMON

SECOND SCHEDULE (7 NOTIFICATIONS)  
-----

- 1 RESERVATIONS AND CONDITIONS IN THE CROWN GRANT(S)
- 2 LAND EXCLUDES MINERALS LAND EXCLUDES MINERALS BY THE CROWN GRANTS  
OF PORTIONS 9, 10, 37, 39, 40, 41 AND 64 AND THE 1.487 HECTARE  
AND 2.651 HECTARE GRANTS
- 3 LAND EXCLUDES THE ROAD(S) SHOWN IN THE TITLE DIAGRAM
- 4 J186887 EASEMENT FOR LEVEE AND ACCESS AFFECTING THE PIECE  
OF LAND VARIABLE WIDTH SHOWN IN THE TITLE DIAGRAM
- 5 5737583 MORTGAGE TO COMMONWEALTH BANK OF AUSTRALIA
- 6 AD471950 MORTGAGE TO COMMONWEALTH BANK OF AUSTRALIA
- 7 AH677638 PROPERTY VEGETATION PLAN FOR EXPIRY DATE SEE DEALING

NOTATIONS  
-----

UNREGISTERED DEALINGS: NIL

\*\*\* END OF SEARCH \*\*\*

PRINTED ON 15/9/2021

LINE	LENGTH
1	37.62
2	124.68
3	253.39
4	191.05
5	241.32
6	140.78
7	60.33
8	60.33
9	166.13
10	172.56
11	110.82
12	76.22
13	113.86
14	76.39
15	111.45
16	23.095
17	110.92
18	198.16
19	140.92
20	143.93
21	34.56
22	70.21

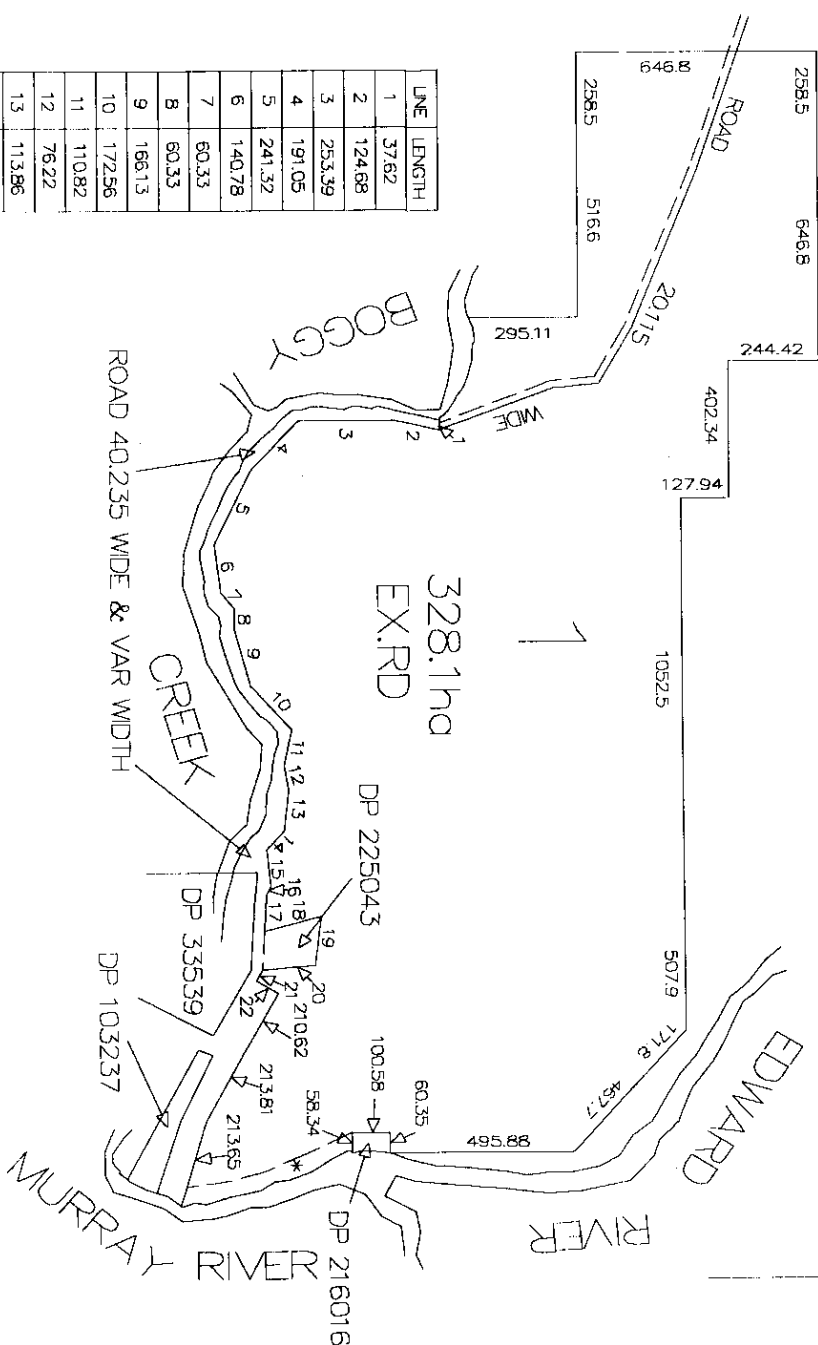

\* J1866887 EASEMENT FOR LEVEE &amp; ACCESS

$$\sum$$

DP 1001440

Registered: 7.5.1999

Title System: TORRENS

Purpose: DEPARTMENTAL

Ref. Map: PARISH:

Last Plan: DP225043#

PLAN OF PART OF LOT 1

IN: DP 557625

G.D.B.

N	O	O	1	D	1	B
---	---	---	---	---	---	---



7.5.1999